

TECTUS®

The completely concealed hinge system

distributed in North America by :



1-800-362-1484
www.BridgeportWorldwide.com



TECTUS® – THE COMPLETELY CONCEALED HINGE SYSTEM

"Making something invisible is also design!" There is a certain appeal in designing items in such a way that their actual value is initially in the background, thereby giving space to other elements. Flush mounting is a stylistic principle that exudes minimalism and involves precise technology and perfection. The TECTUS series of concealed hinges offers unsurpassed quality, versatility and depth. The completely concealed hinge system TECTUS has been an integral part of the SIMONSWERK range since 2002. Thanks to its ongoing development, TECTUS is today more innovative and efficient than ever.

TECTUS® – THE ADVANTAGES AT A GLANCE

- › completely concealed hinge system
 - › for flush-fitting architectural structures
 - › with load capacity of 60 to 300 kg
 - › comfortable 3D adjustment
 - › with an opening angle of 180°
 - › for unrebated and rebated flush doors
 - › for rebated doors
 - › for timber, steel and aluminium frames
 - › with maintenance-free slide bearing technology
-





TECTUS ENERGY – FOR PERMANENT ENERGY TRANSFER

TECTUS Energy enables permanent energy transfer, without compromising on the design aspect of surface-flush appearances. It combines design, function and technology in an exemplary way and creates opportunities for new ideas. For fitting and operating electronic components in high-quality heavy-duty doors, the safe and permanent energy transfer is decisively important. TECTUS Energy secures the door leaf and permanently provides energy from the side of the frame without weakening the door or frame geometry. The technology provided together with TECTUS Energy offers compatibility with all standard versions of locks and fittings, while retaining all technical and optical features of the TECTUS product brand.

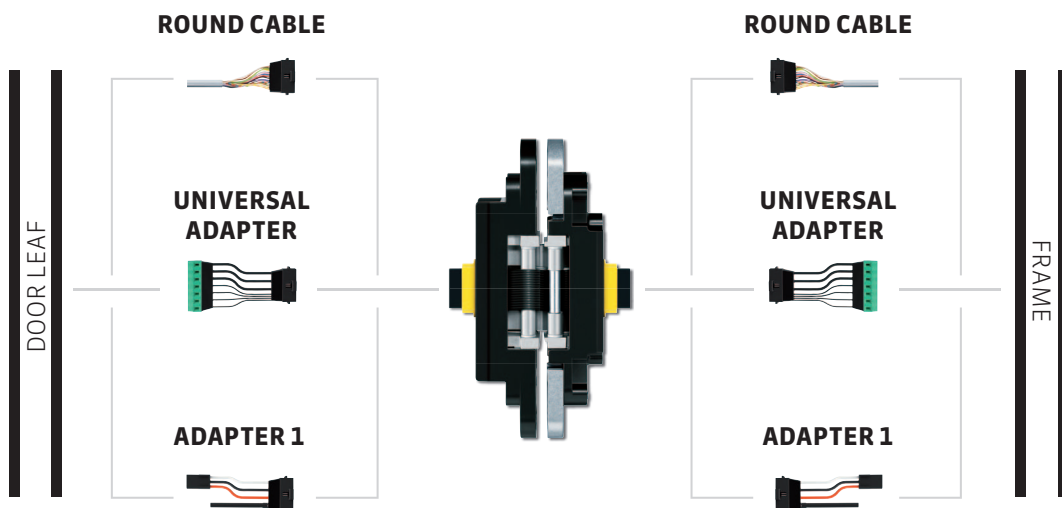

SIMONSWERK
TECTUS®

distributed in North America by :



1-800-362-1484

www.BridgeportWorldwide.com

TE 640 3D

For flush high performance commercial doors

hinge

Technical Details

load capacity	440 lbs
overall length	9.449 "
width (door)	1.260 "
width (frame)	1.260 "
router bit Ø	3/4 "
opening angle	180° degree

Descriptive Text

SIMONSWERK TECTUS TE 640 3D hinge. Completely concealed for flush doors with wood, steel and aluminum frames. UL listed for 20 minute rated fire doors, with user-friendly 3-way adjustments, load capacity up to 200 kg (440 lbs.), opening angle up to 180°, overall length 240 mm (9.360"), non-handed, maintenance-free slide bearings, three-dimensionally adjustable: side +/- 3,0 mm (0.118"), height +/- 3,0 mm (0.118"), compression +/- 1,0 mm (0.039"). Finish...

Note

The load capacity mentioned above refers to the use of 2 hinges per door leaf with a height/width ratio of 2:1.

For a minimum door panel thickness of 40 mm (1-5/8").

For fire rated doors: Check with door manufacturer regarding the usage of additional required intumescent material.

Square-corner cover plates are available upon request.

The load capacity shall be reduced by 20% when installed in combination with a door closer.

Product Features

Completely concealed hinge system

For wood, steel or aluminum door panels and frames

For flush high performance commercial doors

Finger protection due to a small gap between door and frame

Easily adjustable in three dimensions (side +/- 3.0 mm (0.118"), height +/- 3.0 mm (0.118"), compression +/- 1.0 mm (0.039"))

Maintenance-free slide bearings

Functional Areas

fire resistance, smoke resistance, soundproof und forced entry resistance

Quality Marks

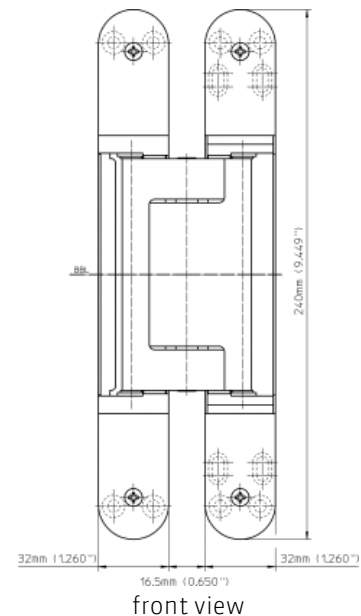

SIMONSWERK

TECTUS®

TE 640 3D

For flush high performance commercial doors

hinge

Combination

receivers	TE 640 3D FZ/1
receivers	TE 640 3D SZ
receivers	TE 640 3D/640 3D A8 ST

Installation Tools

universal milling frame	
template 5 250659 5	24 mm router bit / 30 mm collar ring (step 1)
template 5 250689 5	24 mm router bit / 30 mm collar ring (step 2)
template 5 251062 5	3/4" router bit / 1" collar ring (step 1)
template 5 251063 5	3/4" router bit / 1" collar ring (step 2)

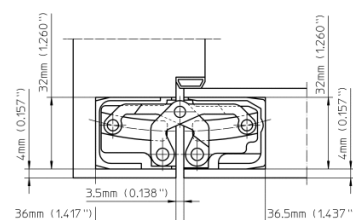

commercial wood frames

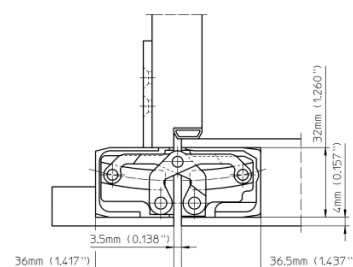

casing wood frames

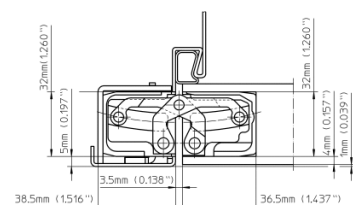

hollow metal frames

SIMONSWERK

TECTUS®

TE 640 3D

For flush high performance commercial doors

hinge

Items (DIN Reference: non-handed)

Finish(es)	polished brass
packing unit	pack of 2
Item Number	5 400613 0 03002
Finish(es)	polished nickel
packing unit	pack of 2
Item Number	5 400613 0 03802
Finish(es)	traffic white - RAL 9016
packing unit	pack of 2
Item Number	5 400613 0 07002
Finish(es)	powder-coated
packing unit	EUR-pallet
Item Number	5 400613 0 07975
Finish(es)	matte deep black - RAL 9005
packing unit	pack of 2
Item Number	5 400613 0 10702
Finish(es)	satin chrome look (F1)
packing unit	pack of 2
Item Number	5 400613 0 12402
Finish(es)	satin nickel look (F2)
packing unit	pack of 2
Item Number	5 400613 0 12502
Finish(es)	stainless steel look (SSL)
packing unit	pack of 2
Item Number	5 400613 0 12602
Finish(es)	satin-nickel
packing unit	pack of 2
Item Number	5 400613 0 14402
Finish(es)	satin chrome
packing unit	pack of 2
Item Number	5 400613 0 14602
Finish(es)	rustic umber
packing unit	pack of 2
Item Number	5 400613 0 15602
Finish(es)	bronze metallic
packing unit	pack of 2
Item Number	5 400613 0 16802
Finish(es)	bronze finish
packing unit	pack of 2
Item Number	5 400613 0 17402
Finish(es)	bronze finish light
packing unit	pack of 2
Item Number	5 400613 0 17502
Finish(es)	bronze finish dark
packing unit	pack of 2
Item Number	5 400613 0 17602

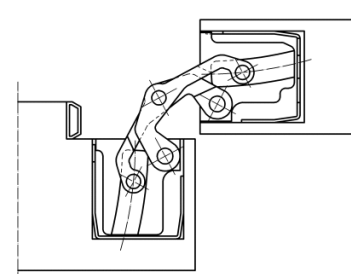

block frame 90°

SIMONSWERK TECTUS®

TE 640 3D

For flush high performance commercial doors

hinge

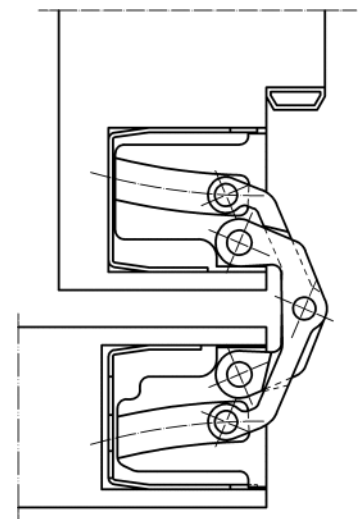

block frame 180°

While every due care has been taken, we cannot be held responsible for errors, omissions or defects. We kindly ask for your understanding.

© SIMONSWERK North America, Inc.